

## Installing the library Proxy on your computer Using Google Chrome

1. Click on the 3 dots icon to open the “Customize and control Google Chrome” menu and click on “Settings”.

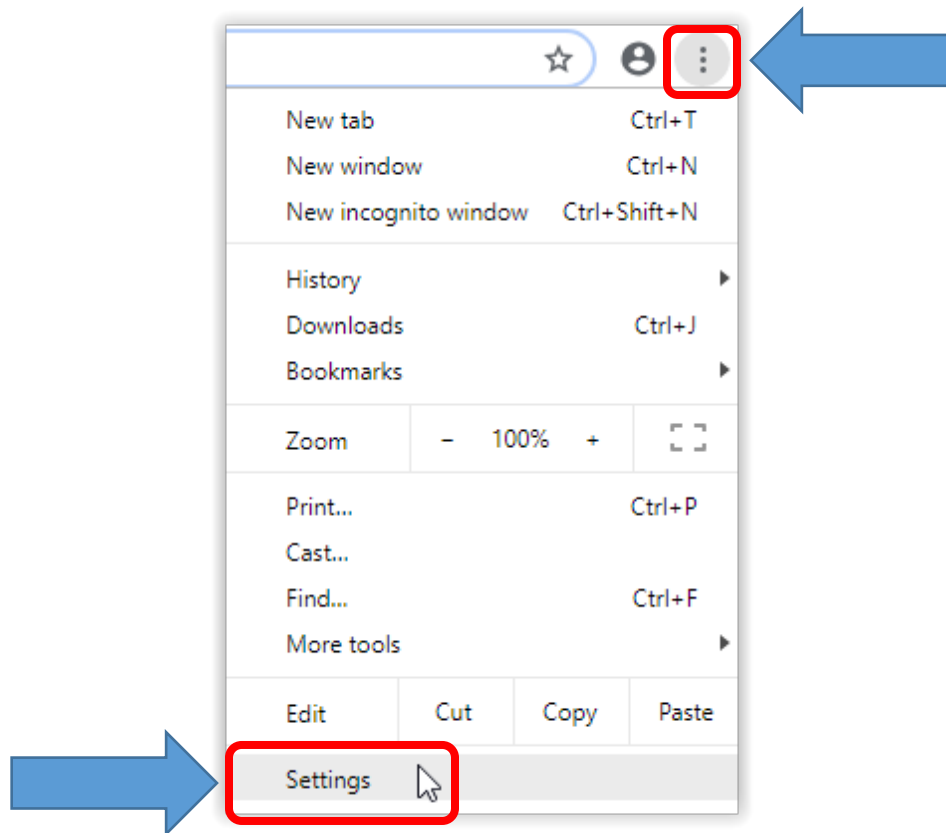

2. The “Settings” page will open.

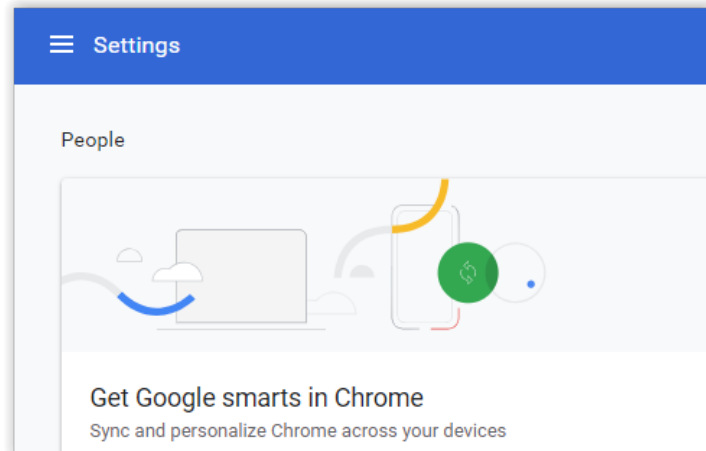

3. Scroll down and click on “Advanced”.
4. Click on “System”.

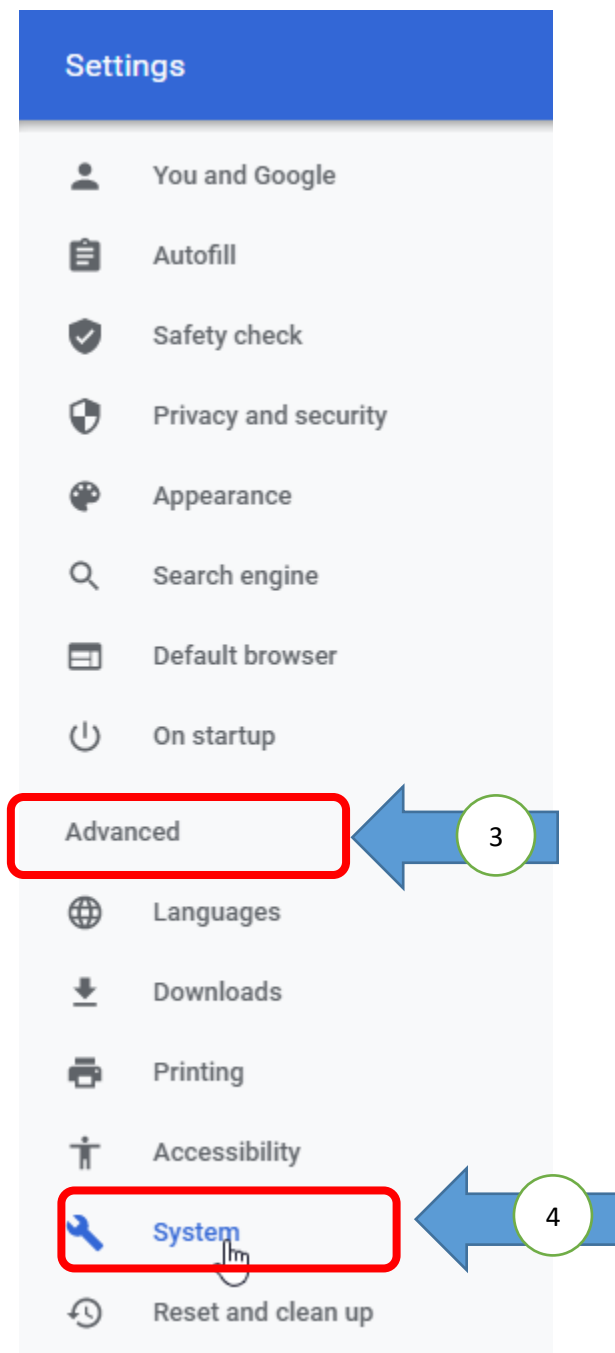

5. Click on “Open your computer’s proxy settings”

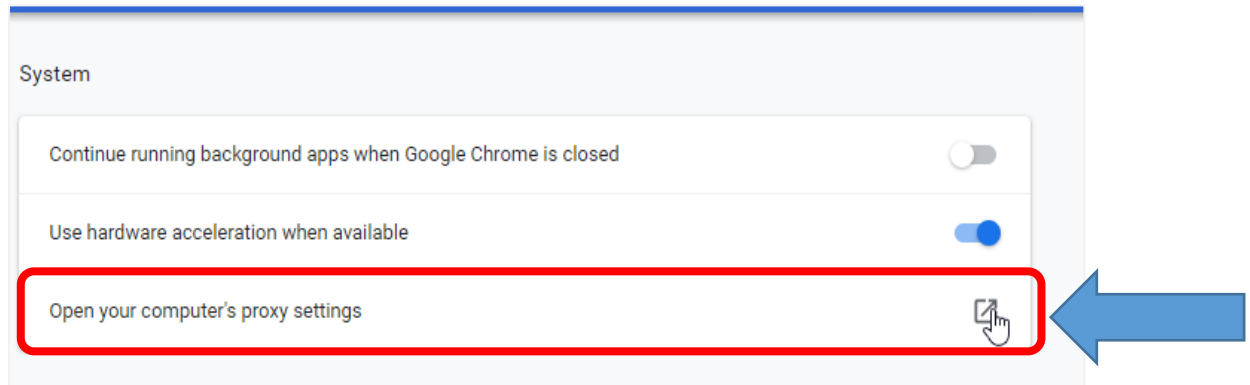

6. The “Proxy” window will open.

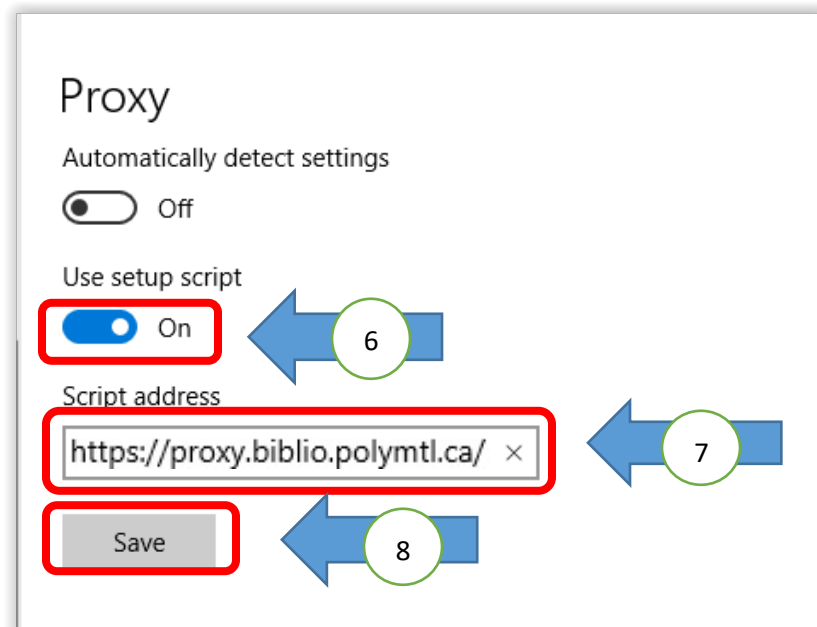

7. Slide the “Use setup script” button to the “On” position.
8. In the “Script Address” window, type <https://proxy.biblio.polymtl.ca/>.
9. Click “Save”.