

## User Guide – CSA OnDemand<sup>MC</sup>

CSA OnDemand contains over 4,000 standards. The interface is available in French and in English.

Access the database: [https://store.csagroup.org/ondemand/s/?language=en\\_US](https://store.csagroup.org/ondemand/s/?language=en_US)

### Create an Account

It is very important to **create a personal account** with **Self-register now** and not to use the Polytechnique generic account.

Once you have registered, you will be automatically logged into your account. This way, in the Web Viewer, you will be able to annotate documents (add personal notes, highlight passages), create a list of favorite documents and make purchase suggestions (wish list).

In the Web Viewer, if you do not see the annotation options, **it means you are logged into the generic Polytechnique account, and not in your personal account** (as seen by clicking on the three dots at the top right of the page and placing the cursor over Sign out). Click on Sign out.

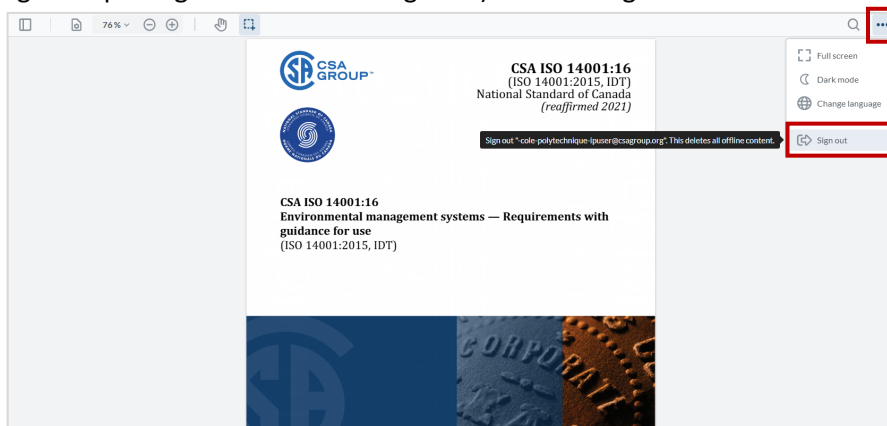

You will be returned to the CSA OnDemand home page. Log out and then log back in with your personal account information.

The image displays two screenshots of the CSA OnDemand website interface.

**Top Screenshot: CSA OnDemand™ - Home**

- Header:** Includes the CSA Group logo, navigation links (CSA Group, CSA Communities, Contact Us, CSA Store), and a 'Logout' button highlighted with a red box. A language selector shows 'English / CAD'.
- Search Bar:** Contains 'My Library' and 'Search Products' with a search icon.
- Section Header:** 'CSA OnDemand™ - Home'.
- Welcome Message:** 'Welcome to École Polytechnique CSA Group subscription.'
- Support:** A link to 'acquisitions@polymtl.ca'.
- Authentication Info:** States the user's IP is associated with a CSA Subscription and they are automatically authenticated. It instructs users to click on 'My Library' or 'Search' to view documents.
- Quick Links:** A button labeled 'My Library →'.
- Registration Instructions:**
  - Encourages creating an account by clicking 'Self-register now'.
  - Provides a list of features: Add personal notes, Create a Favourites list, Print, Copy/paste content, Offline access, Request additional documents, and Choose preferred site language.
  - Includes a note: '\* Only available if covered by your organization's contract'.
- Footer:** A 'Self-register now →' link.

**Bottom Screenshot: CSA OnDemand™ - Customer Login**

- Header:** Similar to the top page, but includes a 'Login' link and a 'Wishlist' icon.
- Section Header:** 'CSA OnDemand™ - Customer Login'.
- Description:** Explains that CSA OnDemand™ is for accessing purchased content, subscriptions, order history, and account details.
- Are you...:**
  - Someone who has purchased content from the CSA Store?** Instructs users to log in to access recently purchased content.
- Perhaps you are...:**
  - Someone given access to content by a company administrator?** Explains that shared access requires registration and that users should contact their administrator if they haven't received an invitation.
- Or perhaps you are...:**
  - Part of a school, library or company that has purchased a subscription?** Explains that authentication is automatic within the approved IP range and that users should contact their administrator if having trouble logging in.
- Login Form (highlighted with a red box):**
  - Title:** 'Log in to CSA OnDemand™ & My Account'.
  - Fields:** 'Username' and 'Password' input boxes.
  - Buttons:** A blue 'Log in' button.
  - Links:** 'Forgot your password?' and 'Create an account'.

There are two ways to create a personal account:

1. Click **Self-register now** at the bottom of the home page:

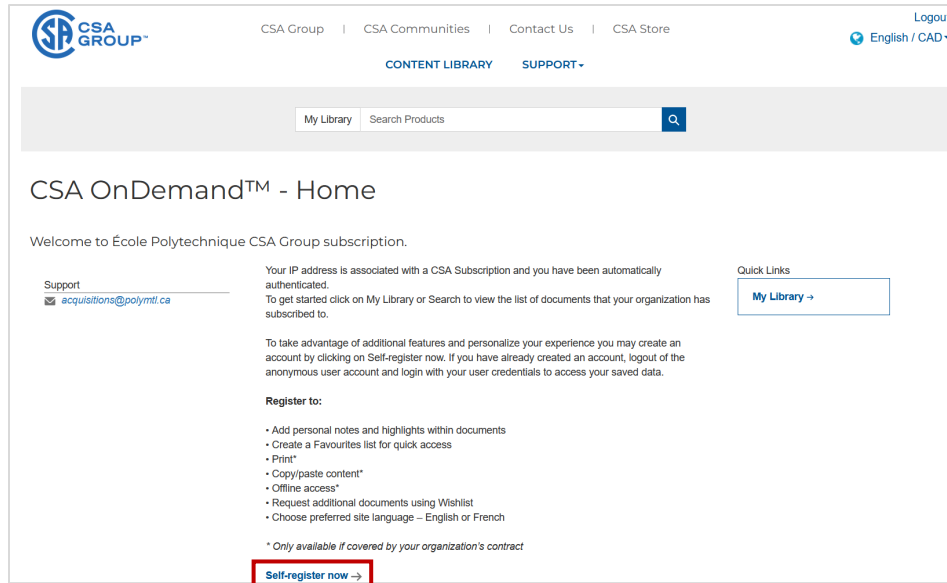

2. Click [https://store.csagroup.org/ondemand/s/login/SelfRegister?language=en\\_US](https://store.csagroup.org/ondemand/s/login/SelfRegister?language=en_US)

Use your Polytechnique email.

## Search for a Standard

To see all standards covered by our subscription, click **Content Library** or **My Library**.

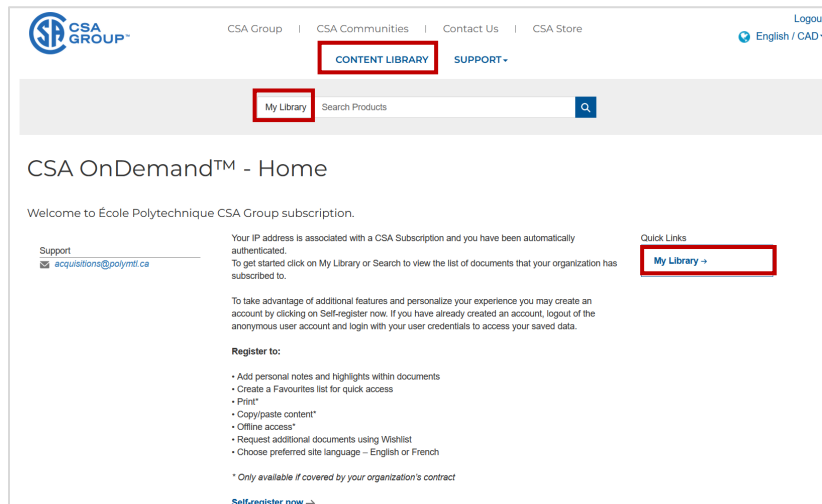

CSA OnDemand does not have an advanced search mode. In the search box, enter the standard number or keywords from its title. In the results list, click on the standard number ("parent" of the standard) or on the small arrow to see the active and previous versions ("children") of the standard.

Click on a "child" to access the full text (see the **View Online** and **Download a PDF** sections in this guide).

CSA GROUP™

CSA Group | CSA Communities | Contact Us | CSA Store

Logout  
English / CAD

CONTENT LIBRARY SUPPORT

My Library iso 14001

## CSA OnDemand™ - My Library

Your search resulted in 554 documents for "iso 14001"

Document List Favourites Showing: 1 - 10 of 554 Documents View 20 View 100

Designation	Title	Status	Year
PLUS 14001 (1st ed. pub. 2017)	The ISO 14001 essentials - A practical guide to implementing the ISO 14001 standard	Active	2017
<b>CSA ISO 14001:16 (R2021)</b>	Environmental management systems — Requirements with guidance for use (Adopted ISO 14001:2015, third edition, 2015-09-15)	Active	2016
PLUS 1164 (1st ed. pub 2002)	A Practical Handbook for Combining the Requirements of ISO 9001:2000 and ISO 14001:1996	Withdrawn	2002
PLUS 1157 (1st ed. pub 2002)	Guide to the Implementation of an EMS for the Primary Agriculture Sector Based on ISO 14001	Withdrawn	2002
PLUS 1150 (1st ed. pub 2001)	Guide to the Implementation of an EMS for the Office Sector Based on ISO 14001 (A joint publication of The Ministry of the Environment, CSA International, Enbridge Consumers Gas, and Union Gas)	Withdrawn	2001

Subject Area

CSA Group ICS Code

All Categories (554)  
Petroleum & Natural Gas (16)  
Environment & Natural Resources (8)  
Construction & Infrastructure (1)  
Health Care and Well-being (81)  
Worker & Public Safety (29)  
Management Systems (64)  
Electrical (323)  
Show More

Language

Publisher

Publication Year

Document Type

CSA GROUP™

CSA Group | CSA Communities | Contact Us | CSA Store

Logout  
English / CAD

CONTENT LIBRARY SUPPORT

My Library iso 14001

## CSA OnDemand™ - My Library

Your search resulted in 554 documents for "iso 14001"

Document List Favourites Showing: 1 - 10 of 554 Documents View 20 View 100

Designation	Title	Status	Year
<b>CSA ISO 14001:16 (R2021)</b>	Environmental management systems — Requirements with guidance for use (Adopted ISO 14001:2015, third edition, 2015-09-15)	Active	2016
CSA ISO 14001:F16 (C2021)	Systèmes de management environnemental — Exigences et lignes directrices pour son utilisation (norme ISO 14001:2015 adoptée, troisième édition, 2015-09-15)	Active	2016
CAN/CSA-ISO 14001-04 (R2014)	Environmental Management Systems - Requirements With Guidance for Use (Adopted ISO 14001:2004, second edition, 2004-11-15)	Withdrawn	2004

Share Add to Favourites

### CSA ISO 14001:16 (R2021)

Environmental management systems — Requirements with guidance for use (Adopted ISO 14001:2015, third edition, 2015-09-15)

**View Online**

**Download PDF\***

Downloaded PDF document must be opened using the desktop version of Adobe Reader or Acrobat

For academic users, the PDF document cannot be accessed off campus. Please use online version.

Details Overview

If you use keywords in English to search for a specific standard, you may also find results in French.

\* **Please note:** If you are off campus, use the **View Online** option. If you download the PDF, you will not be able to open it from off campus:

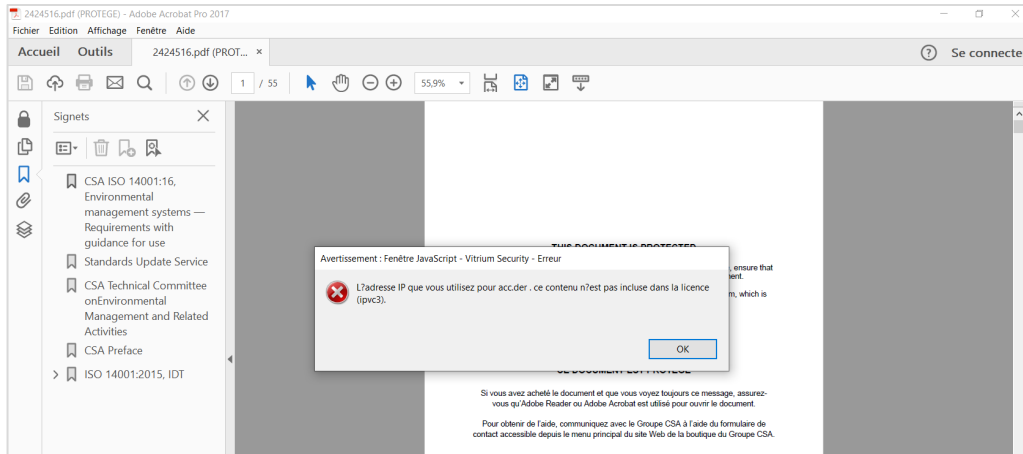

## View Online

This option opens the standard in the Web Viewer.

It is possible to **annotate** a standard and access your notes later, but you should first create a personal account (see the **Create an Account** section of this guide).

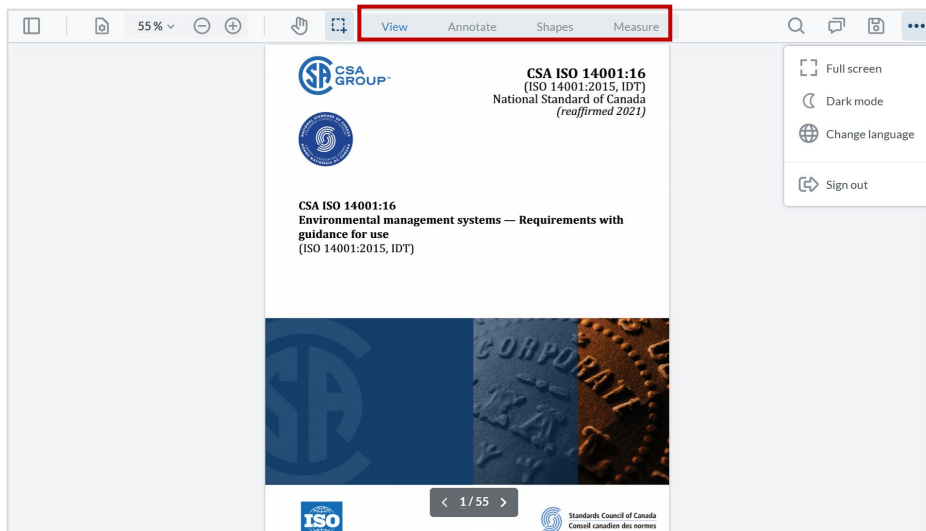

## Download a PDF

The PDF file should be opened with the **desktop version** of Adobe Reader or Adobe Acrobat (it will not work if opened in a browser).

After clicking **Download PDF** (see page 4), retrieve the PDF on your computer (in the Downloads folder), then right-click the PDF and choose **Open with > Adobe Acrobat**.

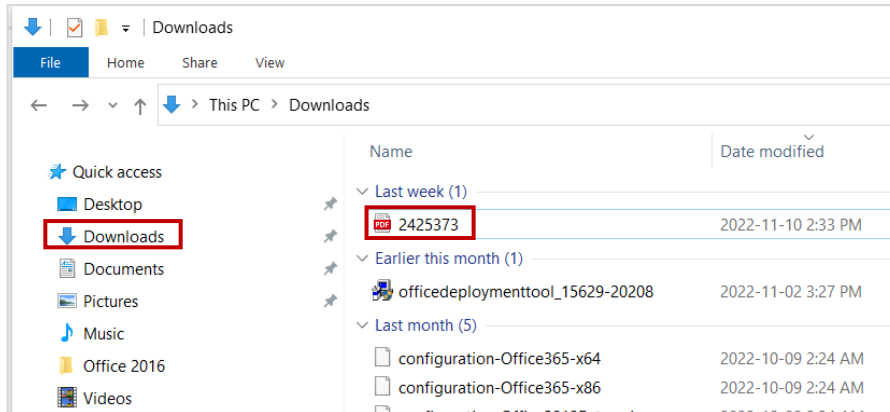

When opening a PDF, an error message may appear in Adobe Acrobat:

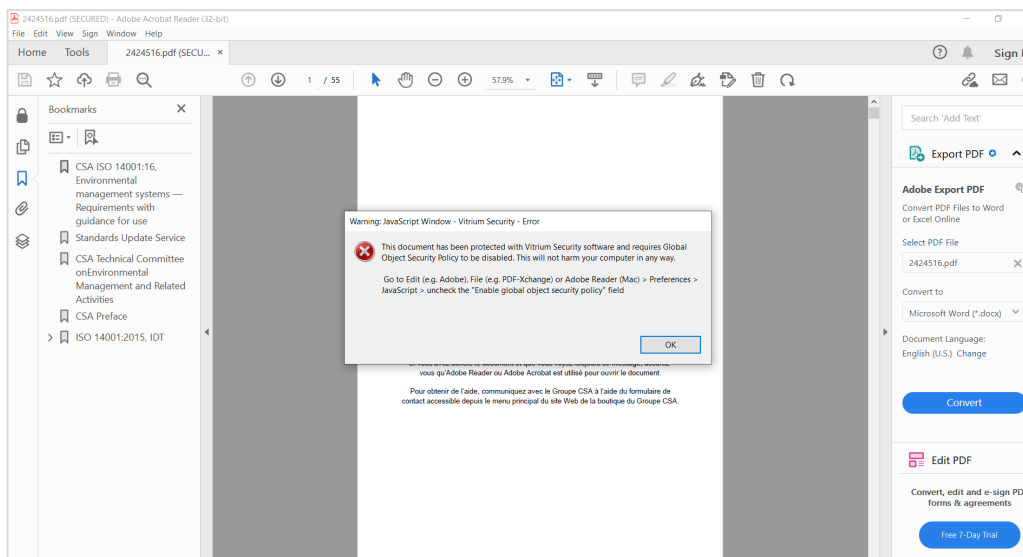

Click **OK**. If the **PDF does not open**, follow the instructions in the error message (for Windows or Mac).

## Do You Need Help?

Email: [biblio@polymtl.ca](mailto:biblio@polymtl.ca)

Chat: [BiblioPoly has answers!](#)